

THICKSON ROAD (REG. RD. 26)

SCALE 1:500

SUPPLEMENTAL LEGEND - DETOUR

- TRAFFIC FLOW
- STAGE 2 TEMPORARY DETOUR
- STAGE 2 UNDER CONSTRUCTION
- TC-54 DELINEATORS

- GENERAL DETOUR NOTES:**
- ALL DETOUR PI CHAINAGE OFFSETS ARE BASED ON CL OF CONSTRUCTION (THICKSON RD.). SEE TIE SHEET FOR LAYOUT DETAILS.
 - TC-54 DELINEATORS TO BE PLACED ALONG COMPLETE DETOUR. MAXIMUM SPACING 8 m EXCEPT AS NOTED.
 - TRAFFIC CONTROL DEVICES AND CONSTRUCTION SIGNAGE BY CONTRACTOR TO BE IN ACCORDANCE WITH OPSS 543, OTM BOOK 7 (MARCH 2001) RMDCS SECTION 01550.
 - THE SIGNAGE AND MARKING PLAN SHOWN IS FOR CONSIDERATION ONLY. CONTRACTOR IS RESPONSIBLE FOR WORK ZONE AND MAY CHANGE OR ADD SIGNS AND MARKINGS TO SUIT CONDITIONS.

PAVEMENT MARKING LEGEND

IDENTIF.	TYPE	COLOUR	WIDTH (cm)
1	SOLID	YELLOW	10
5	SOLID	WHITE	10
6	3-3-3 BROKEN	WHITE	10
14	SOLID	WHITE	45
20	SYMBOLS	-	-
] OR [LIMITS OF MARKINGS	-	-

- PAVEMENT MARKING DENOTATION:**
- 3-3-3, 3-6-3, 3-9-3; LINE-GAP-LINE SPACING IN METRES
 - (1) PERMANENT
 - (1) DURABLE

- NOTES:**
- ALL MARKINGS AND SIGNS SHALL CONFORM WITH THE ONTARIO TRAFFIC MANUAL (OTM), BOOK 11.
 - PROPOSED MARKINGS TO MATCH EXIST. AT ALL WORK AND/OR ROAD RECONSTRUCTION LIMITS.
 - ALL LANE MARKINGS TO BE PLACED BY THE CONTRACTOR PRIOR TO OPENING THE ROAD TO TRAFFIC.
 - ALL EXISTING SIGNS TO BE RESTORED AND RELOCATED IF REQUIRED.
 - MOUNTING HEIGHT & LATERAL OFFSET OF SIGNS PER ONTARIO TRAFFIC MANUAL (OTM), BOOK 1B - SECTION 12.

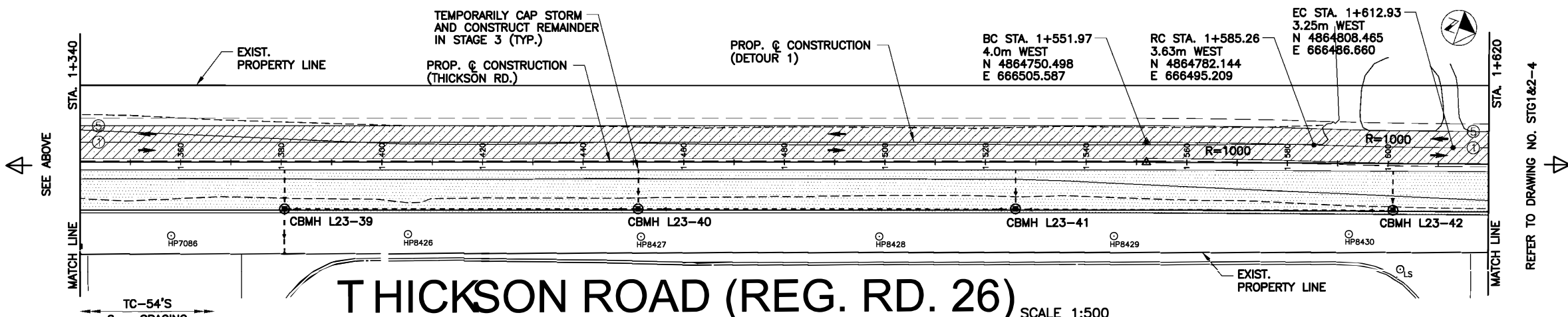

THICKSON ROAD (REG. RD. 26)

SCALE 1:500

- STAGE 1 TRAFFIC:**
- ON EXISTING
- STAGE 1 CONSTRUCTION:**
- CONSTRUCT STORM SEWER STA. 0+142.3 (CB 42) TO STA. 0+127.1 (DIMH K23-14)
 - CONSTRUCT STORM SEWER OUTFALL STA. 0+616.7 (DCBMH K23-21) TO STA. 0+626.88 (OUTFALL)
 - CONSTRUCT TEMPORARY SIGNALS AT WINTERBERRY DR. & DRYDEN BLVD.
 - REMOVE DRYDEN BLVD. CENTRE MEDIAN
 - PAVE EXISTING WEST SHOULDER: STA. 0+214 TO 0+486 STA. 0+505 TO 0+648 STA. 0+721 TO 1+106 STA. 1+133 TO 1+750
 - REMOVE PORK CHOP ISLAND AT SOUTH ENTRANCE TO NO FRILLS PARKING LOT
 - LINE PAINTING AND SIGN SET UP FOR STAGE 2 (DETOUR 1)
- STAGE 2 TRAFFIC:**
- SHIFT TRAFFIC TO WEST PAVED SHOULDER (DETOUR 1)
- STAGE 2 CONSTRUCTION:**
- CONSTRUCT EAST SIDE OF THICKSON RD. (8 m) WITH 1 LIFT OF BASE ASPHALT
 - CONSTRUCT WINTERBERRY DR. (EXCEPT WITHIN THICKSON RD.)
 - CONSTRUCT DRYDEN BLVD. (EXCEPT WITHIN THICKSON RD.)
- STAGE 2B CONSTRUCTION:**
(TO BE DONE DURING LAST 2 WEEKS OF STAGE 2)
- CONSTRUCT ADDITIONAL ROAD WIDTH ON THICKSON RD. TO ALLOW FOR A LEFT TURN LANE ON THICKSON RD. AT WINTERBERRY DR. & DRYDEN BLVD.

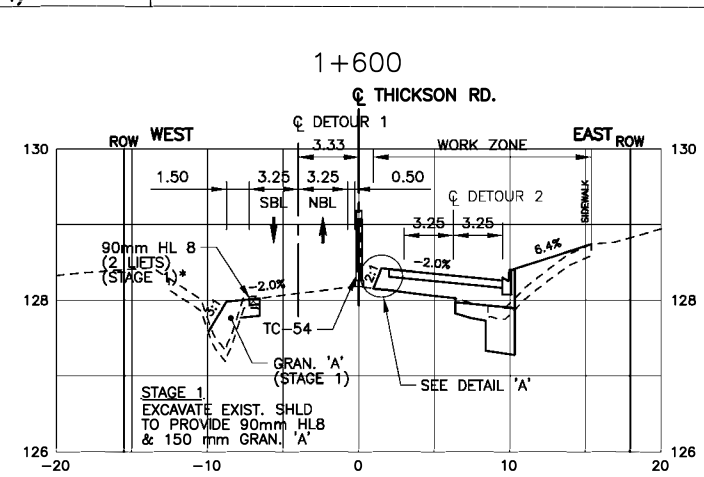
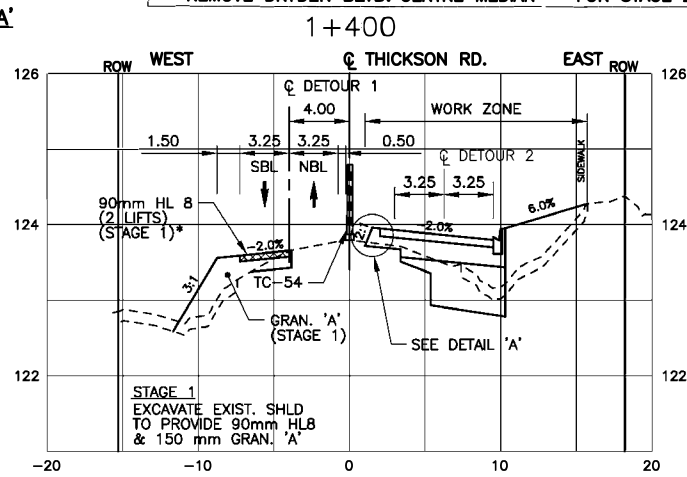
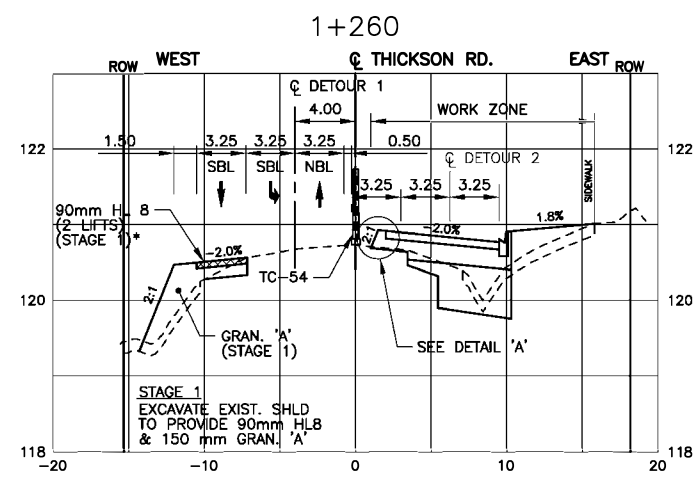
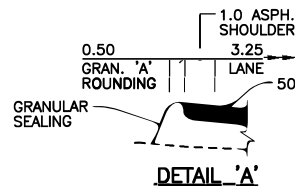

SCALE 1:250 HORIZONTAL
1:50 VERTICAL

NOTE: ALL DIMENSIONS ARE IN METRES UNLESS OTHERWISE NOTED.

NO.	DATE	NAME	REVISIONS
UTILITIES VERIFIED			
		CABLE T.V.	2008 10 31
		BELL CANADA	2008 10 03
		ENBRIDGE GAS	2009 05 01
		WHITBY HYDRO	2008 11 03

APPROXIMATE UTILITY LOCATIONS ARE SHOWN PER MARKUPS RECEIVED FROM THIRD PARTIES ON THE DATES NOTED ABOVE. CONTRACTOR TO BE RESPONSIBLE FOR LOCATION OF ALL EXISTING U/G & OVERHEAD UTILITIES. VARIOUS UTILITIES REQUIRE ADVANCE NOTICE PRIOR TO DIGGING. FOR STAKE OUT. THE REGION ASSUMES NO RESPONSIBILITY FOR THE ACCURACY OF THE LOCATION OF EXISTING UTILITIES AS INDICATED ON THIS.

DRAWING	SURVEY DATA DATE
	2007 03 20
	SCALE
	AS NOTED

DRAWN: X. X.	DATE: 2011 02
DESIGN: X. X.	DATE: 2011 02
CHECKED: X. X.	DATE: 2011 03
APPROVED: X. X.	DATE: 2011 03

THE REGIONAL MUNICIPALITY OF DURHAM
WORKS DEPARTMENT
WHITBY ONTARIO

THICKSON ROAD CONSTRUCTION STAGING PLAN - STAGE 1 & 2 STA. 1+060 TO 1+620

CONCESSION 3	REG. RD. NO. 26	AREA MUNICIPALITY TOWN OF WHITBY
DRAWING NUMBER STG-2	CONTRACT NUMBER D20XX-XXX	SHEET NUMBER 056 OF 110

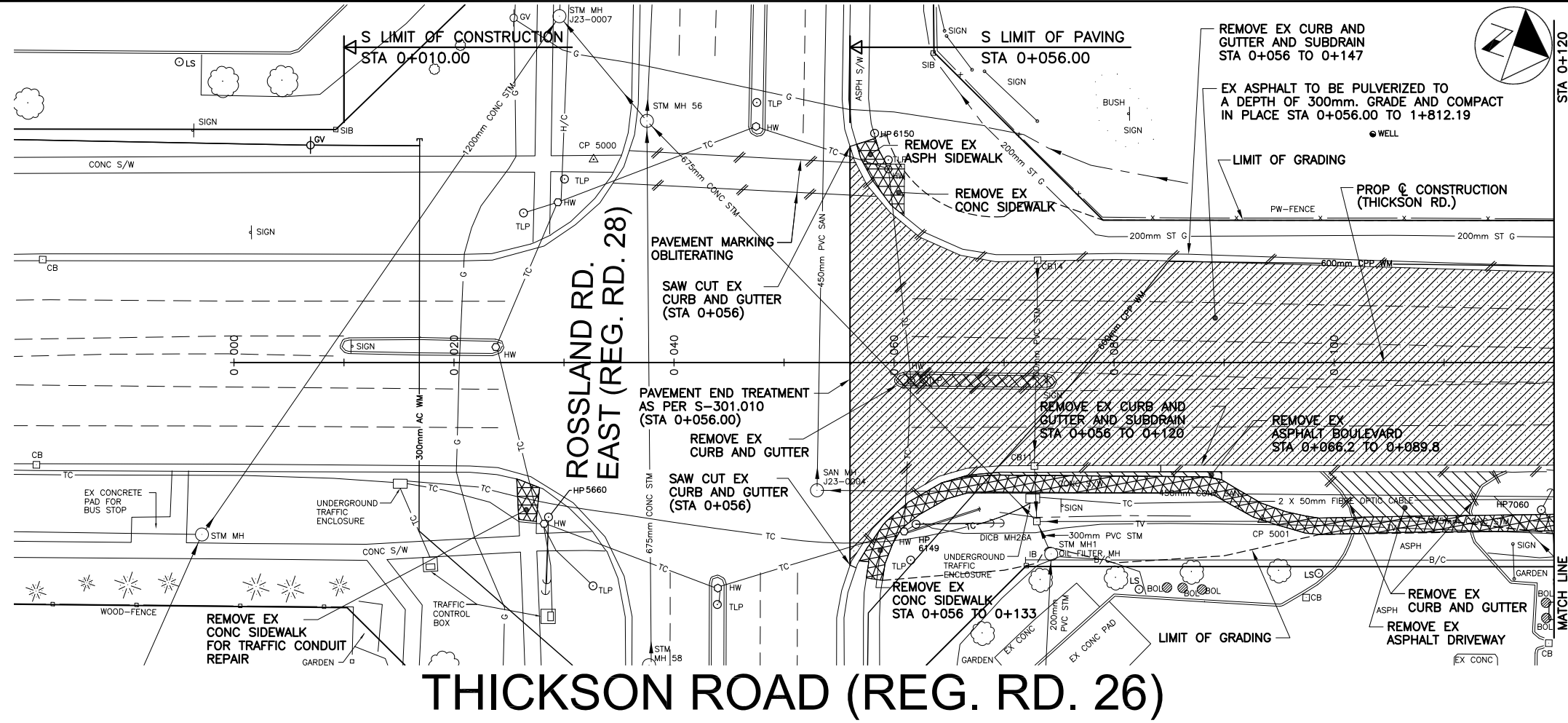

THICKSON ROAD (REG. RD. 26)

- NOTES:**
- ALL REGULATORY SIGNS TO BE KEPT IN USE AT ALL TIMES DURING CONSTRUCTION.
 - FROM STA 0+056 TO 0+084± PLACE 40 mm HL1, 100 mm HD3C, AND 50 mm GRAN A. REMOVE EX GRAN AND PULVERIZED ASPHALT AS REQUIRED.
 - REMOVE EX PULVERIZED ASPHALT AS REQUIRED TO PLACE 150 mm GRAN A AND PROPOSED ASPHALT (WITHIN EX ROAD):
 STA 0+084.25 TO 0+210
 STA 0+590 TO 0+640
 STA 1+130 TO 1+320
 STA 1+380 TO 1+480
 STA 1+750 TO 1+804.81

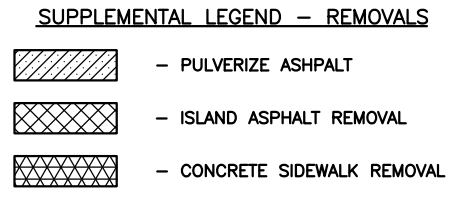

SEE BELOW

MATCH LINE

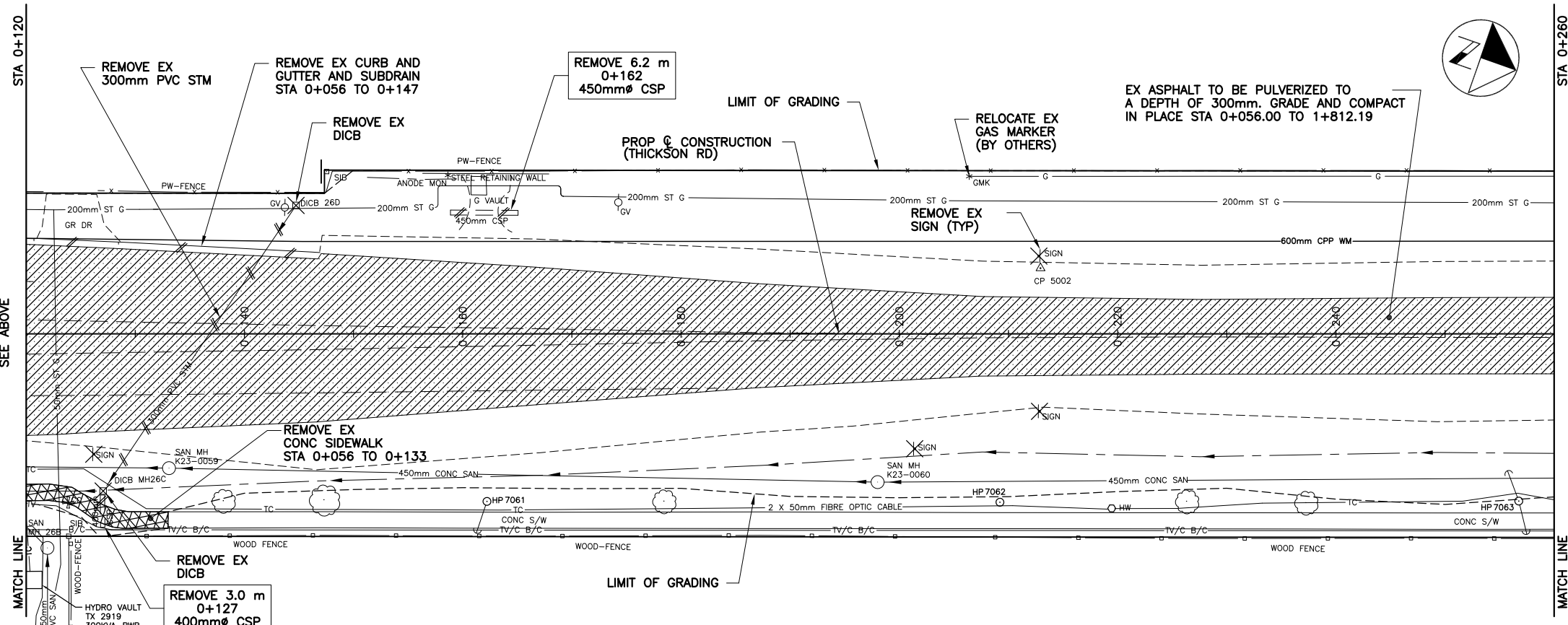

THICKSON ROAD (REG. RD. 26)

NO.	DATE	NAME	REVISIONS

APPROXIMATE UTILITY LOCATIONS ARE SHOWN PER MARK-UPS RECEIVED FROM THIRD PARTIES ON THE DATES NOTED ABOVE. CONTRACTOR TO BE RESPONSIBLE FOR LOCATION OF ALL EXISTING U/G & OVERHEAD UTILITIES. VARIOUS UTILITIES REQUIRE ADVANCE NOTICE PRIOR TO DIGGING, FOR STAKE OUT. THE REGION ASSUMES NO RESPONSIBILITY FOR THE ACCURACY OF THE LOCATION OF EXISTING UTILITIES AS INDICATED ON THIS DRAWING.

SURVEY DATA DATE
2007 03 20

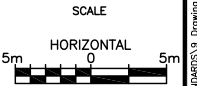

DRAWN: X. XXXX
 DESIGN: X. XXXX
 CHECKED: X. XXXX
 APPROVED: X. XXXX

DATE: 2011 02
 DATE: 2011 02
 DATE: 2011 03
 DATE: 2011 03

THE REGIONAL MUNICIPALITY OF DURHAM
 WORKS DEPARTMENT
 WHITBY ONTARIO

THICKSON ROAD REMOVALS – FROM 25m SOUTH OF ROSSLAND ROAD TO 215m NORTH OF ROSSLAND ROAD

CONCESSION 3	REG. RD. NO. 26	AREA MUNICIPALITY TOWN OF WHITBY
DRAWING NUMBER RM-1	CONTRACT NUMBER D20XX-XX	SHEET NUMBER 008 OF 110

NOTE: ALL DIMENSIONS ARE IN METRES UNLESS OTHERWISE NOTED.

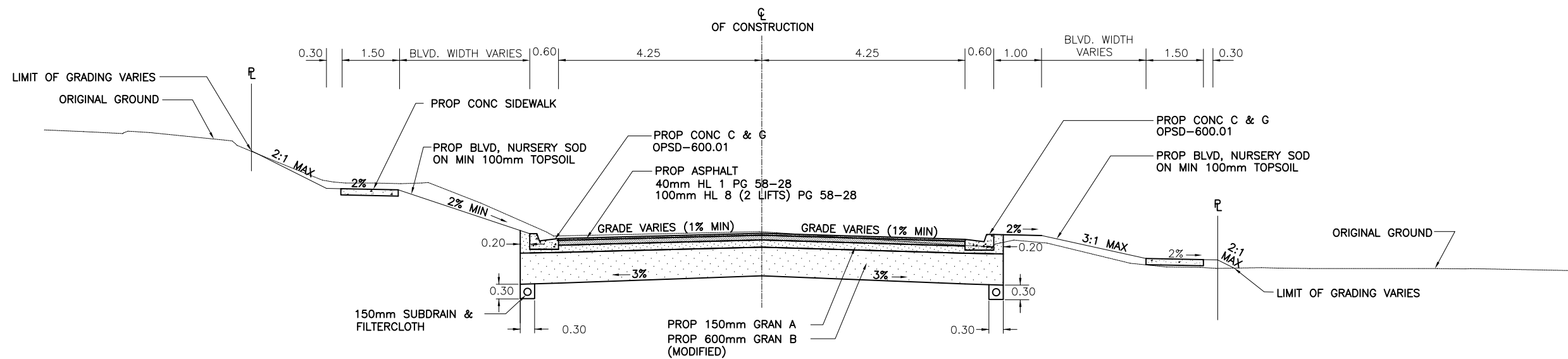

**TYPICAL 2 LANE CROSS-SECTION
STA 9+170 TO ANN STREET AND YORK STREET TO BEAVER RIVER**

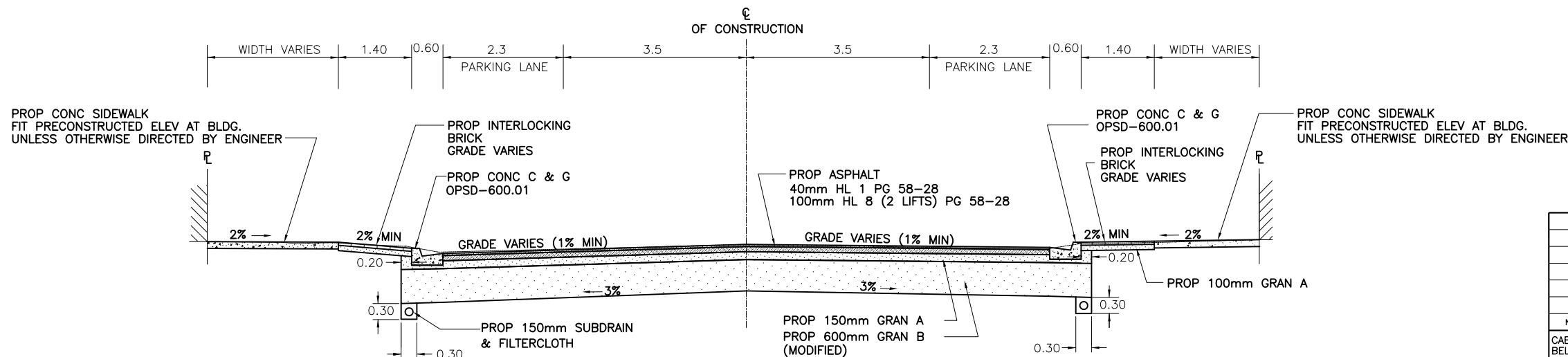

TYPICAL 2 LANE CROSS-SECTION WITH PARKING

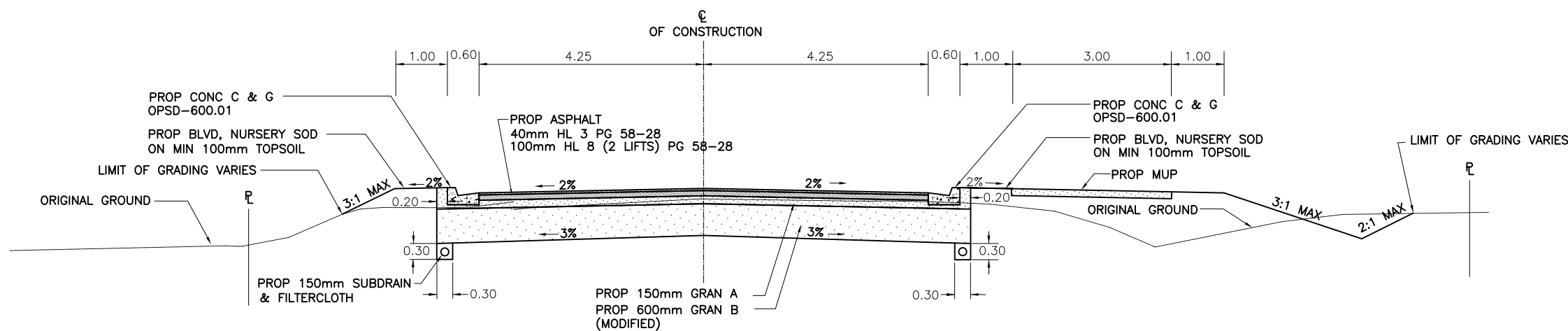

**TYPICAL 2 LANE CROSS-SECTION
SIDEROAD 18 TO STA 9+170**

NO.	DATE	NAME	REVISIONS

APPROXIMATE UTILITY LOCATIONS ARE SHOWN PER MARK-UPS RECEIVED FROM THIRD PARTIES ON THE DATES NOTED ABOVE. CONTRACTOR TO BE RESPONSIBLE FOR LOCATION OF ALL EXISTING U/G & OVERHEAD UTILITIES. VARIOUS UTILITIES REQUIRE ADVANCE NOTICE PRIOR TO DIGGING, FOR STAKE OUT. THE REGION ASSUMES NO RESPONSIBILITY FOR THE ACCURACY OF THE LOCATION OF EXISTING UTILITIES AS INDICATED ON THIS DRAWING.

DRAWN: X, X	DATE: 2004 01
DESIGN: X, X	DATE: 2004 01
CHECKED: X, X	DATE: 2004 01
APPROVED: X, X	DATE: 2004 01

THE REGIONAL MUNICIPALITY OF DURHAM
 WORKS DEPARTMENT
 WHITBY ONTARIO

**STREET NAME
TYPICAL SECTIONS**

CONCESSION	REG. RD NO.	AREA MUNICIPALITY
-	-	CITY OF XXXX

DRAWING NUMBER	CONTRACT NUMBER	SHEET NUMBER
TYP-1	D20XX-XX	04 OF 10

NOTE: ALL DIMENSIONS ARE IN METRES UNLESS OTHERWISE NOTED.

TRAFFIC SIGN SCHEDULE		
SIGN ID	DESCRIPTION	QTY
Ra-1	STOP (RELOCATED)	1
Rb-1(60)	MAXIMUM SPEED 60	2
Rb-25	KEEP RIGHT	1
Wa-33L	OBJECT MARKER	1

STA: 1+695.889 THICKSON ROAD =
STA: 30+000 TOM EDWARDS DRIVE

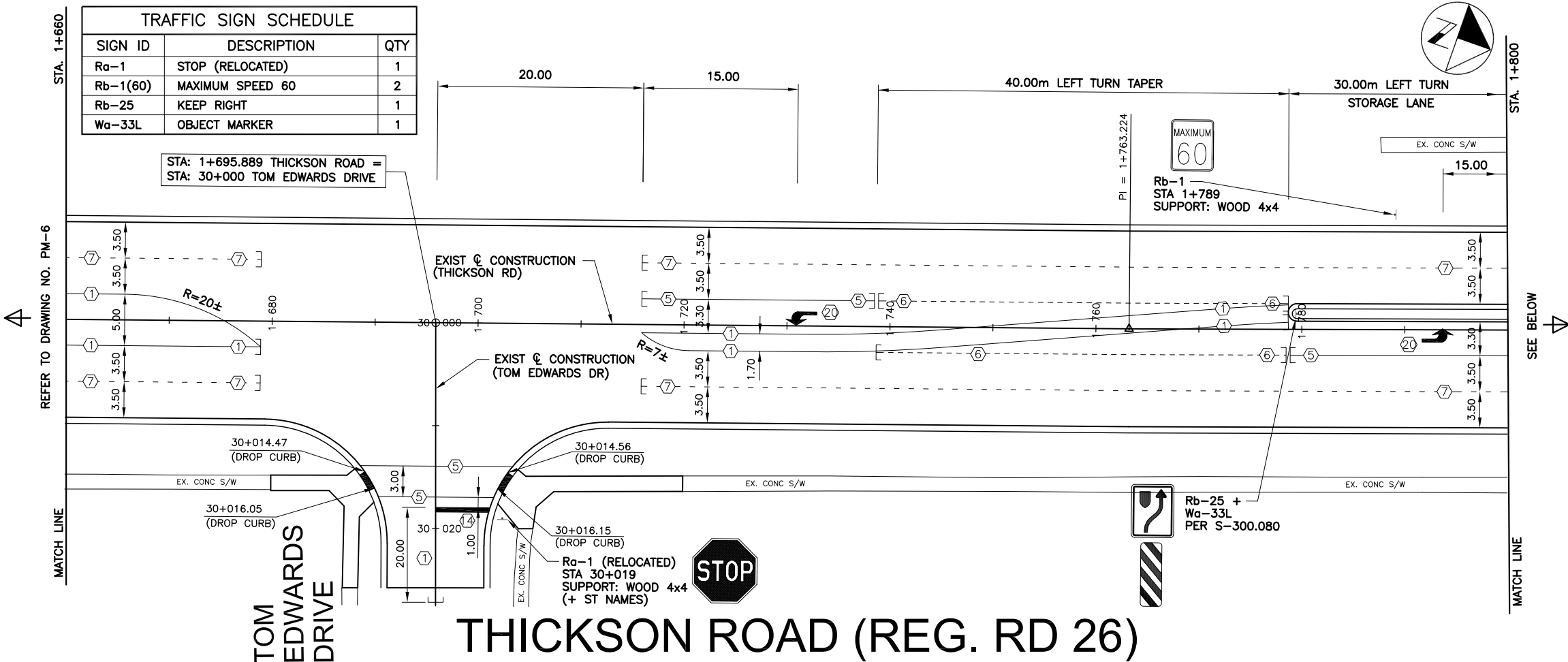

THICKSON ROAD (REG. RD 26)

PAVEMENT MARKING LEGEND			
IDENTIF.	TYPE	COLOUR	WIDTH (cm)
1	SOLID	YELLOW	10
2	DOUBLE SOLID	YELLOW	10
3	3-6-3 BROKEN	YELLOW	10
4	SOLID;3-6-3 BROKEN	YELLOW	10
5	SOLID	WHITE	10
6	3-3-3 BROKEN	WHITE	10
7	3-6-3 BROKEN	WHITE	10
8	3-9-3 BROKEN	WHITE	10
9	SOLID	WHITE	20
10	1-1-1 BROKEN	WHITE	20
11	3-3-3 BROKEN	WHITE	20
12	3-3-3 BROKEN	WHITE	30
13	SOLID	WHITE	30
14	SOLID	WHITE	45
15	SOLID	WHITE	60
16	1-1-1 BROKEN	WHITE	10
20	SYMBOLS	-	-
] OR [LIMITS OF MARKINGS	-

- PAVEMENT MARKING DENOTATION:
- 3-3-3, 3-6-3, 3-9-3; LINE-GAP-LINE SPACING IN METRES
 - ① PERMANENT
 - ① TEMPORARY
 - ▽ TEMPORARY-REMOVABLE
 - ① DURABLE
 - ① EXISTING MARKING TO BE REMOVED OR (TREATED?)

- NOTES:
- ALL MARKINGS SHALL CONFORM WITH THE ONTARIO TRAFFIC MANUAL (OTM), BOOK 11.
 - PROPOSED MARKINGS TO MATCH EXIST AT ALL WORK AND/OR ROAD RECONSTRUCTION LIMITS.
 - LONGITUDINAL MARKINGS - PAINT ON BASE COURSE AND PLASTIC ON TOP COURSE.
 - TRANSVERSE MARKINGS/SYMBOLS - PLASTIC ON BOTH BASE AND TOP COURSE.
 - SIGN MOUNTING HEIGHTS, AND LATERAL OFFSETS SHALL BE IN ACCORDANCE WITH THE ONTARIO TRAFFIC MANUAL (OTM) BOOK 1B, SECTION 12.

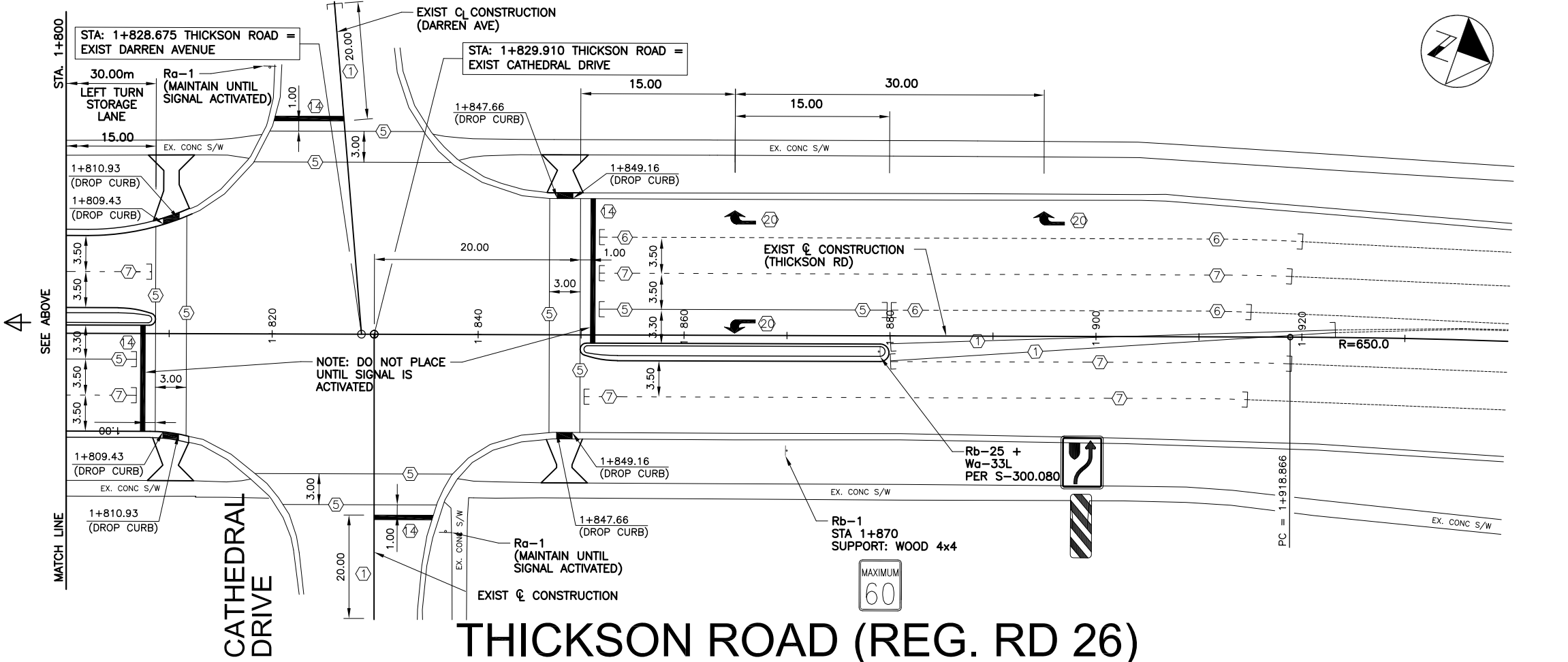

THICKSON ROAD (REG. RD 26)

NO.	DATE	NAME	REVISIONS

CABLE T.V. XXXX XX XX WHITBY HYDRO XXXX XX XX
 BELL CANADA XXXX XX XX
 ENBRIDGE GAS XXXX XX XX

APPROXIMATE UTILITY LOCATIONS ARE SHOWN PER MARK-UPS RECEIVED FROM THIRD PARTIES ON THE DATES NOTED ABOVE. CONTRACTOR TO BE RESPONSIBLE FOR LOCATION OF ALL EXISTING U/G & OVERHEAD UTILITIES. VARIOUS UTILITIES REQUIRE ADVANCE NOTICE PRIOR TO DIGGING, FOR STAKE OUT. THE REGION ASSUMES NO RESPONSIBILITY FOR THE ACCURACY OF THE LOCATION OF EXISTING UTILITIES AS INDICATED ON THIS DRAWING.

SURVEY DATA DATE

SCALE

HORIZONTAL

DRAWN:	DATE:
DESIGN:	DATE:
CHECKED:	DATE:
APPROVED:	DATE:

THE REGIONAL MUNICIPALITY OF DURHAM

WORKS DEPARTMENT

WHITBY ONTARIO

THICKSON ROAD

PAVEMENT MARKINGS AND SIGNAGE
 FROM 35m SOUTH OF TOM EDWARDS DRIVE
 TO 95m NORTH OF CATHEDRAL DRIVE

CONCESSION	REG. RD NO.	AREA MUNICIPALITY
3	26	TOWN OF WHITBY
DRAWING NUMBER	CONTRACT NUMBER	SHEET NUMBER
PM-1	20XX-XX	10 OF 12

NOTE: ALL DIMENSIONS ARE IN METRES UNLESS OTHERWISE NOTED.

Trees

Key	Scientific Name	Common Name	Quantity	Minimum Size
A	ACER SACCHARUM	SUGAR MAPLE	11	50mm CALIPER.
B	PICEA GLAUCA	WHITE SPRUCE	12	80cm HEIGHT.
C	QUERCUS RUBRA	RED OAK	4	50mm CALIPER.
D	FRAXINU AMERICANA	WHITE ASH	5	50mm CALIPER.
E	SHEPHERDIA CANADENSIS	CANADIAN BUFFALO BERRY	18	80cm HEIGHT.
F	ACER RUBRUM	RED MAPLE	2	50mm CALIPER.
G	THUJA OCCIDENTALIS	WHITE CEDAR	7	120cm HEIGHT.
H	WHITE PINE	WHITE PINE	7	100cm HEIGHT.
I	SYRINGA VULGARIS	COMMON LILAC	12	80cm HEIGHT.

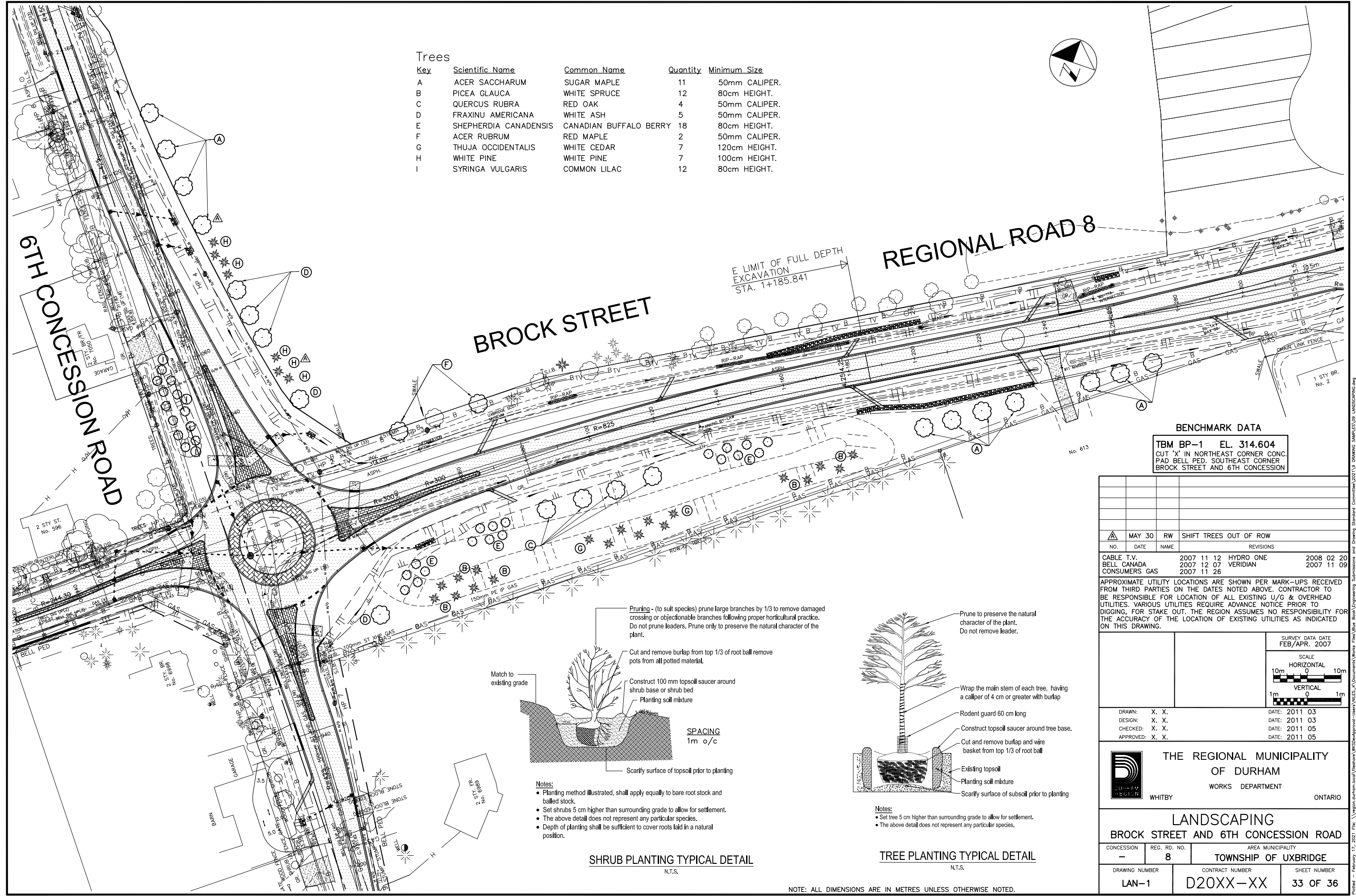

BENCHMARK DATA
TBM BP-1 EL. 314.604
 CUT 'X' IN NORTHEAST CORNER CONC.
 PAD BELL PED. SOUTHEAST CORNER
 BROCK STREET AND 6TH CONCESSION

NO.	DATE	NAME	REVISIONS
△	MAY 30	RW	SHIFT TREES OUT OF ROW
CABLE T.V.	2007 11 12	HYDRO ONE	2008 02 20
BELL CANADA	2007 12 07	VERIDIAN	2007 11 09
CONSUMERS GAS	2007 11 26		

APPROXIMATE UTILITY LOCATIONS ARE SHOWN PER MARK-UPS RECEIVED FROM THIRD PARTIES ON THE DATES NOTED ABOVE. CONTRACTOR TO BE RESPONSIBLE FOR LOCATION OF ALL EXISTING U/G & OVERHEAD UTILITIES. VARIOUS UTILITIES REQUIRE ADVANCE NOTICE PRIOR TO DIGGING, FOR STAKE OUT. THE REGION ASSUMES NO RESPONSIBILITY FOR THE ACCURACY OF THE LOCATION OF EXISTING UTILITIES AS INDICATED ON THIS DRAWING.

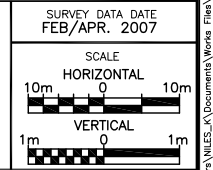

DRAWN: X. X.	DATE: 2011 03
DESIGN: X. X.	DATE: 2011 03
CHECKED: X. X.	DATE: 2011 05
APPROVED: X. X.	DATE: 2011 05

THE REGIONAL MUNICIPALITY OF DURHAM
 WORKS DEPARTMENT
 WHITBY, ONTARIO

LANDSCAPING
BROCK STREET AND 6TH CONCESSION ROAD

CONCESSION	REG. RD. NO.	AREA MUNICIPALITY
-	8	TOWNSHIP OF UXBRIDGE
DRAWING NUMBER	CONTRACT NUMBER	SHEET NUMBER
LAN-1	D20XX-XX	33 OF 36

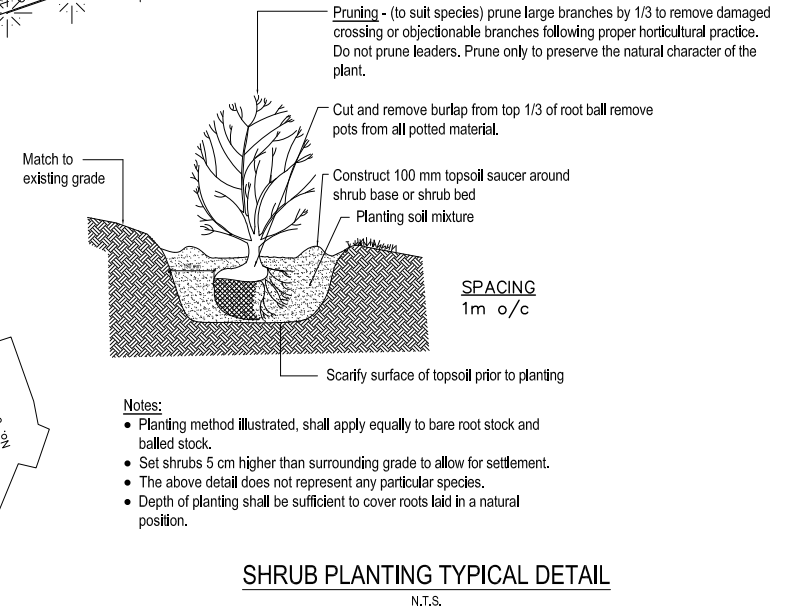

- Notes:**
- Planting method illustrated, shall apply equally to bare root stock and balled stock.
 - Set shrubs 5 cm higher than surrounding grade to allow for settlement.
 - The above detail does not represent any particular species.
 - Depth of planting shall be sufficient to cover roots laid in a natural position.

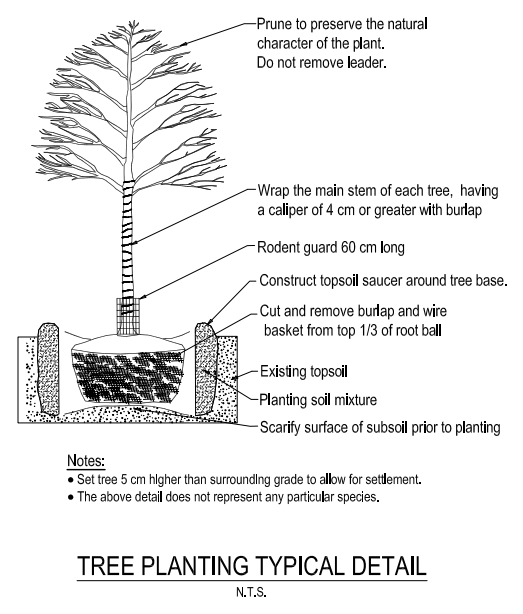

- Notes:**
- Set tree 5 cm higher than surrounding grade to allow for settlement.
 - The above detail does not represent any particular species.

NOTE: ALL DIMENSIONS ARE IN METRES UNLESS OTHERWISE NOTED.

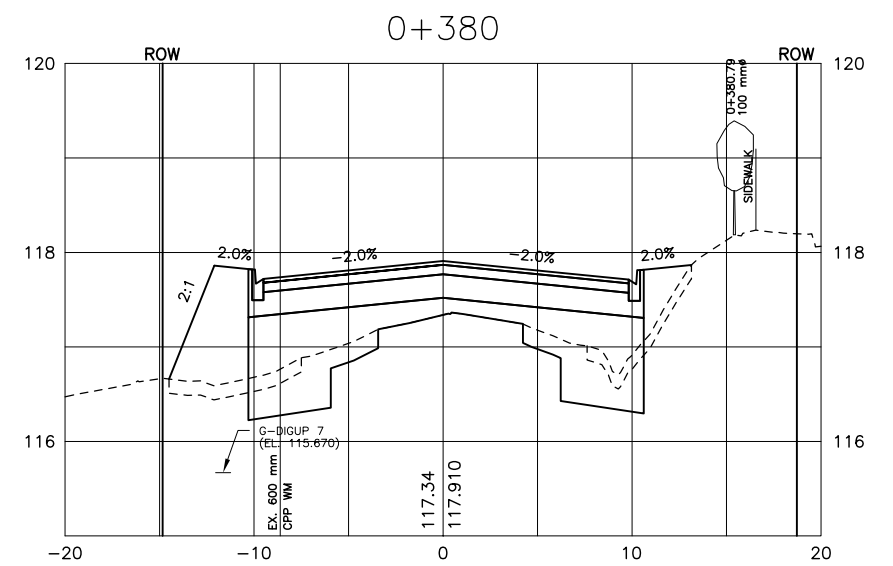
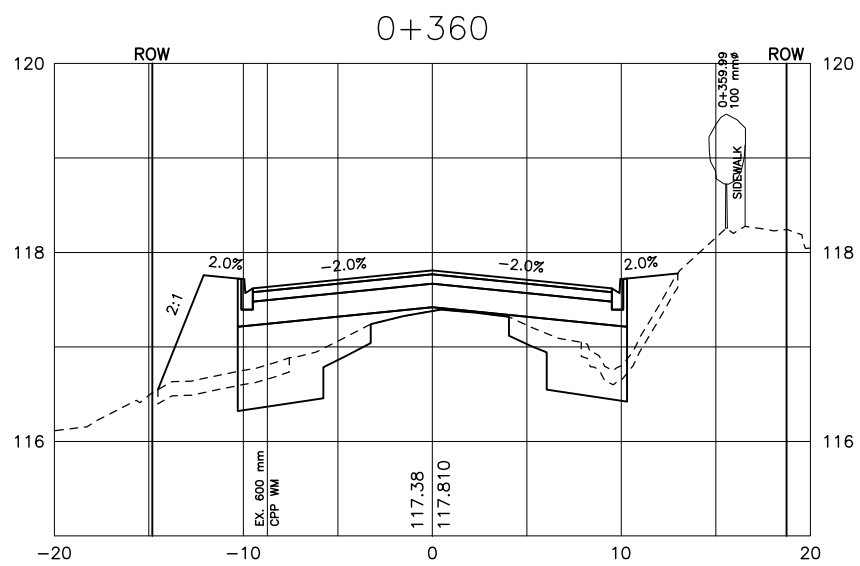
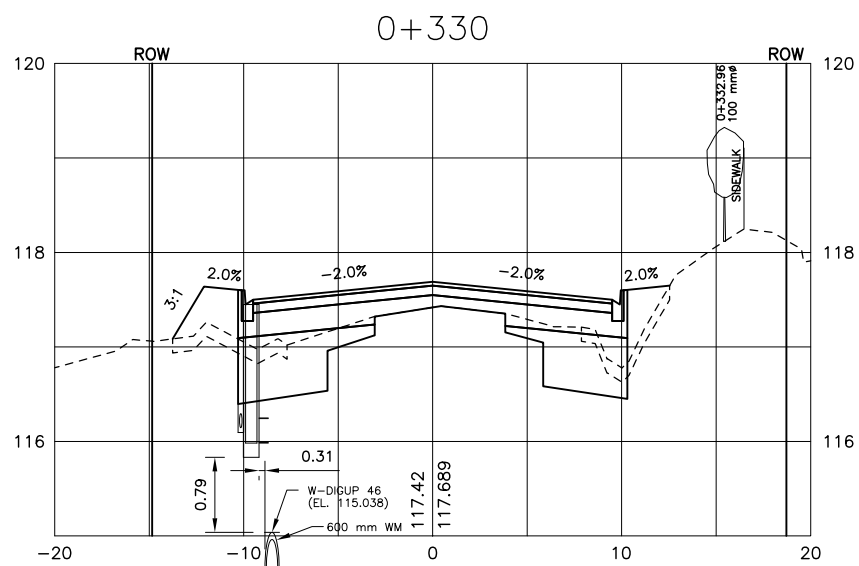
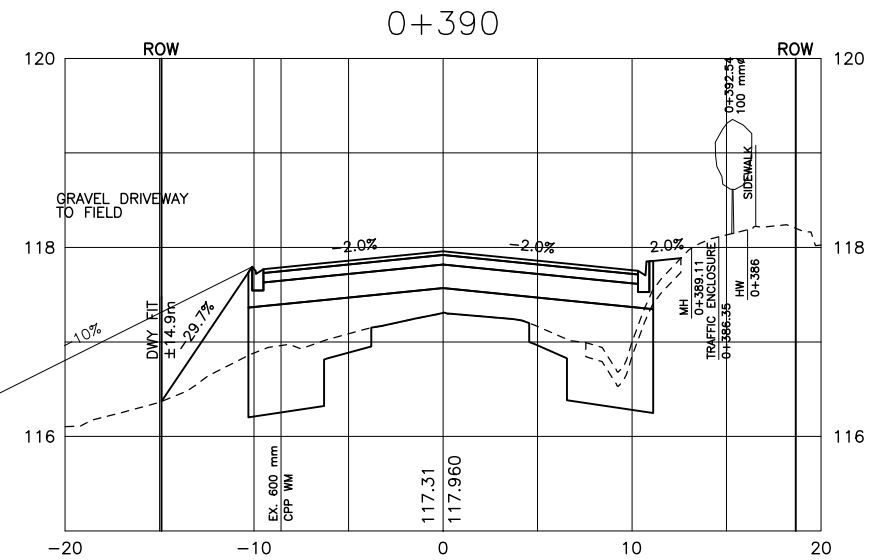
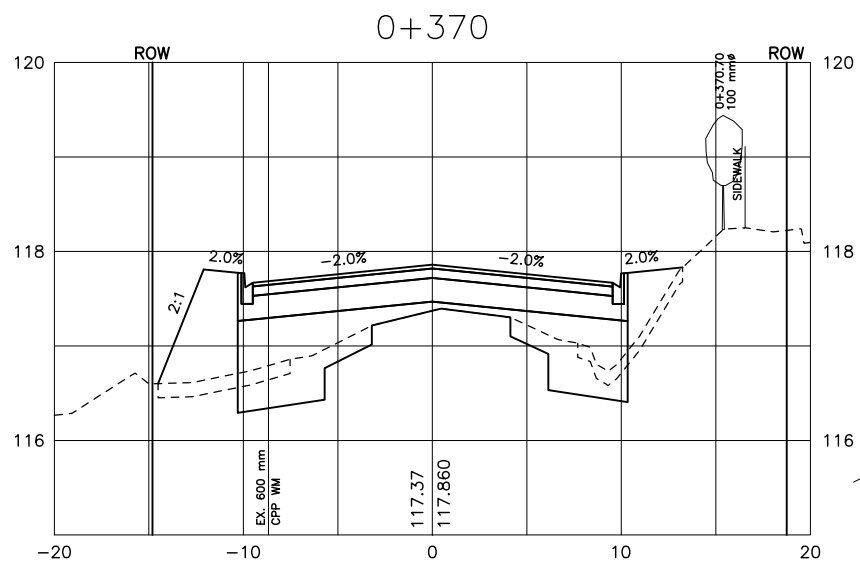
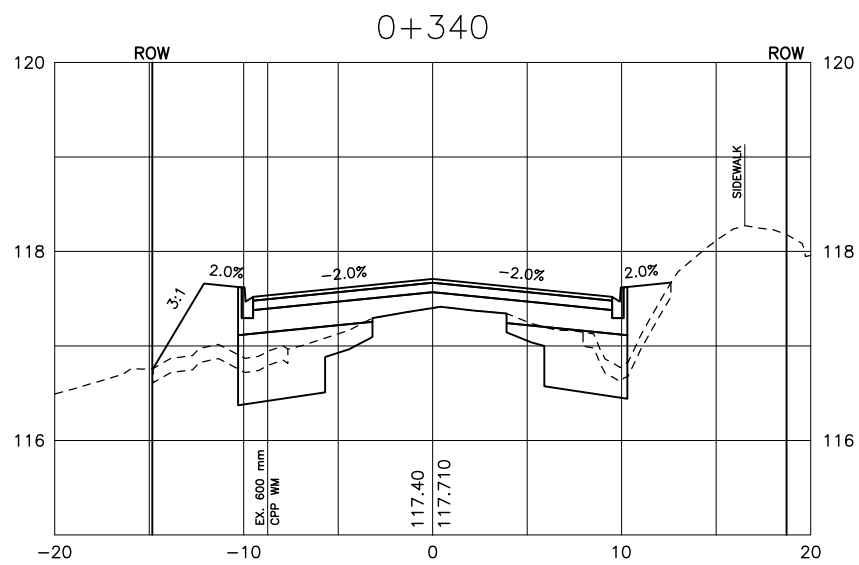
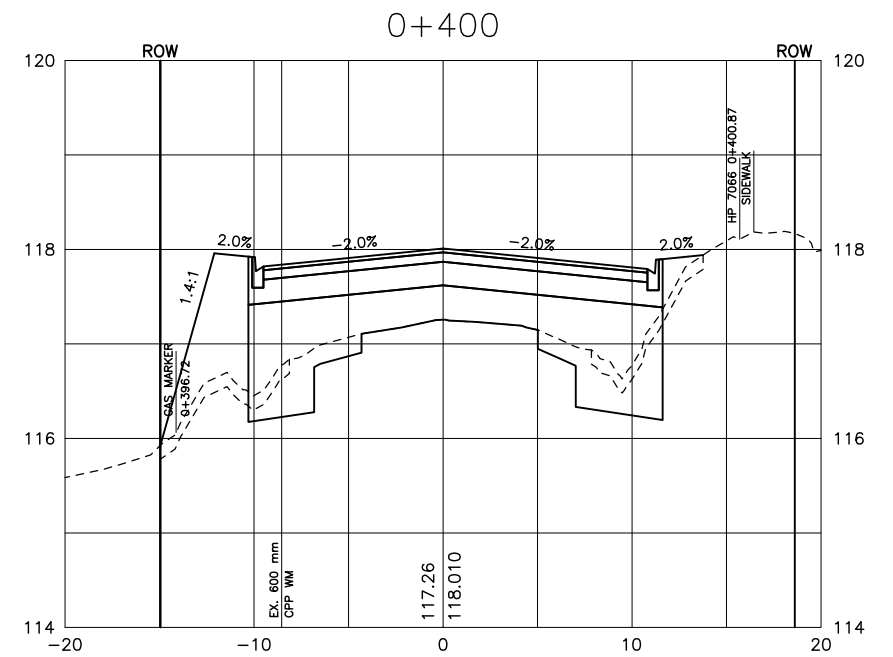
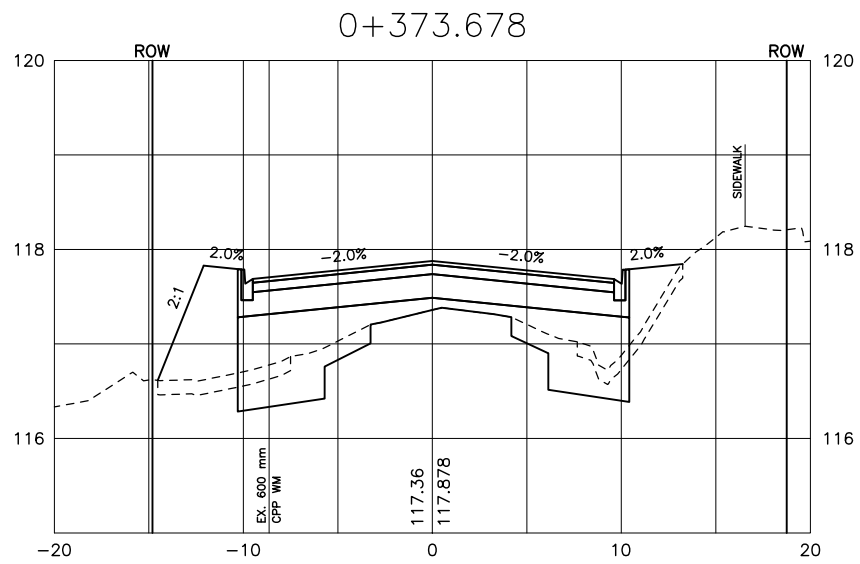
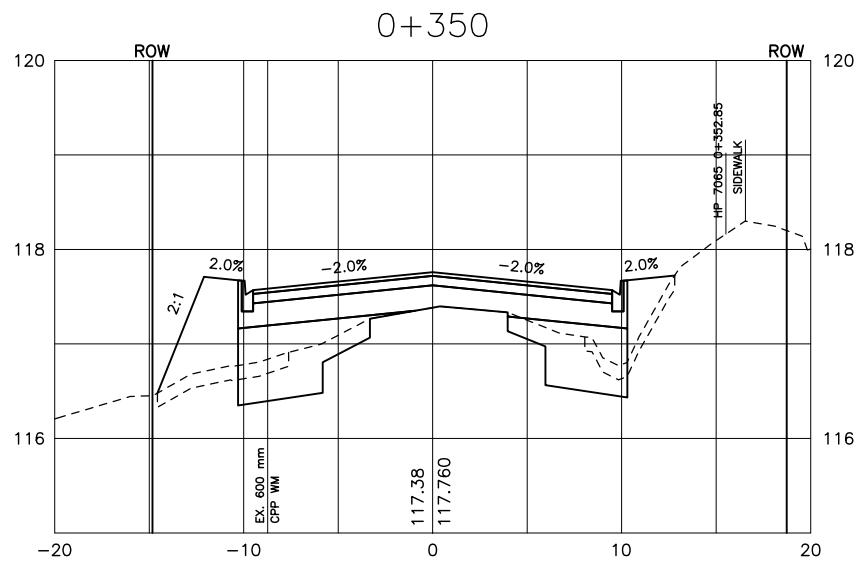

NOTE: ALL DIMENSIONS ARE IN METRES UNLESS OTHERWISE NOTED.

CABLE T.V. 2008 10 31 WHITBY HYDRO 2008 11 03
 BELL CANADA 2008 10 03
 ENBRIDGE GAS 2009 05 01

APPROXIMATE UTILITY LOCATIONS ARE SHOWN PER MARK-UPS RECEIVED FROM THIRD PARTIES ON THE DATES NOTED ABOVE. CONTRACTOR TO BE RESPONSIBLE FOR LOCATION OF ALL EXISTING U/G & OVERHEAD UTILITIES. VARIOUS UTILITIES REQUIRE ADVANCE NOTICE PRIOR TO DIGGING, FOR STAKE OUT. THE REGION ASSUMES NO RESPONSIBILITY FOR THE ACCURACY OF THE LOCATION OF EXISTING UTILITIES AS INDICATED ON THIS DRAWING.

NO.	DATE	NAME	REVISIONS

DRAWN: X. X. DATE: 2011 02
 DESIGN: X. X. DATE: 2011 02
 CHECKED: X. X. DATE: 2011 03
 APPROVED: X. X. DATE: 2011 03

AREA MUNICIPALITY
TOWN OF WHITBY
 SURVEY DATA DATE: 2007 03 20
 CONCESSION: 3
 REG. RD. NO.: 26

THE REGIONAL MUNICIPALITY OF DURHAM
 WORKS DEPARTMENT
 WHITBY ONTARIO

CONTRACT NO.
D20XX-XX

DRAWING NO.
CX-4

SHEET 087 OF 110

THICKSON ROAD
 DESIGN CROSS SECTIONS
 FROM STA. 0+330 TO STA. 0+400

REFER TO DRAWING
NO 0-07-SW-1234

REFER TO DRAWING
NO 0-07-SW-1236

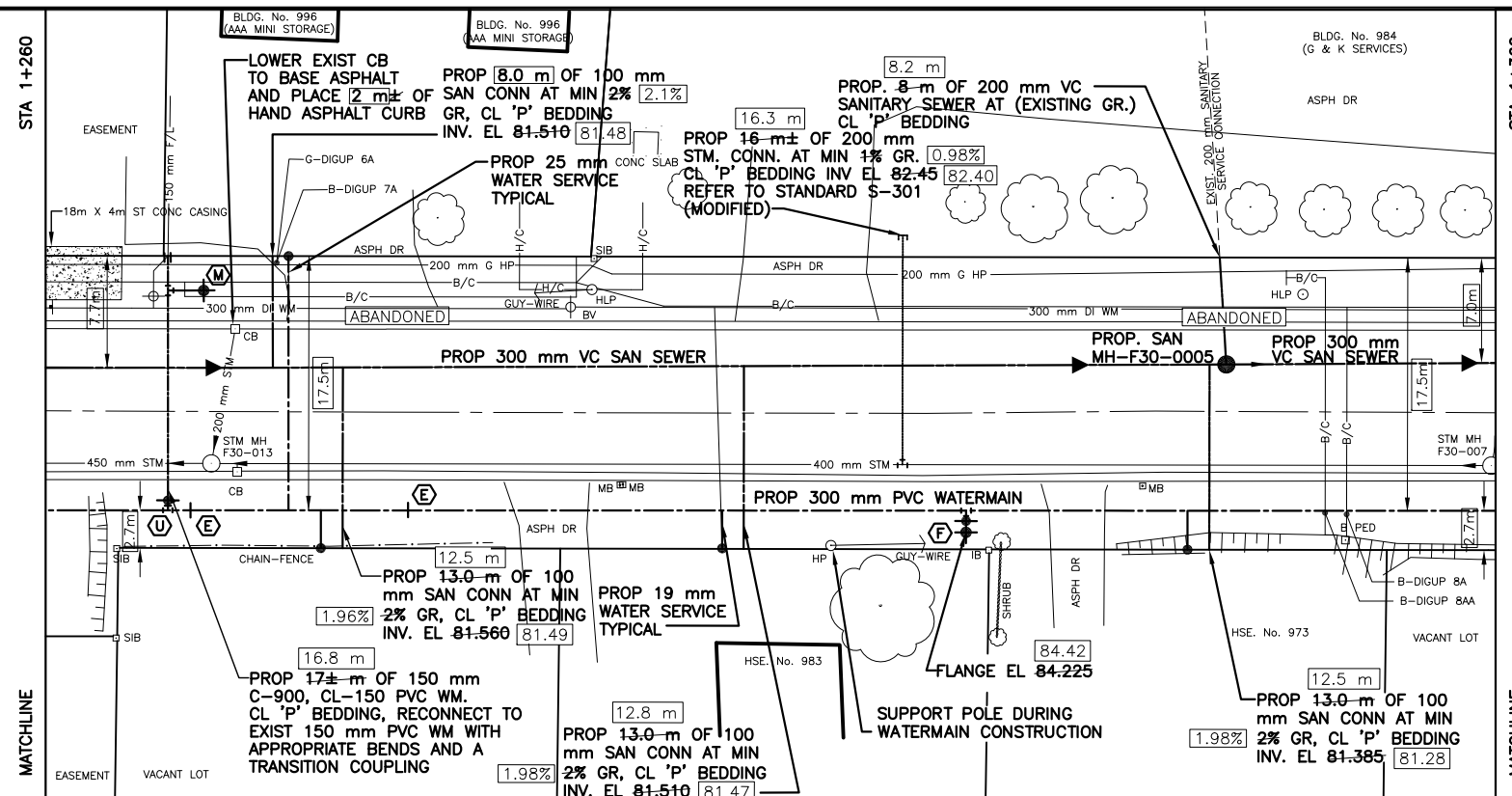

FAREWELL STREET (REG. RD 56)

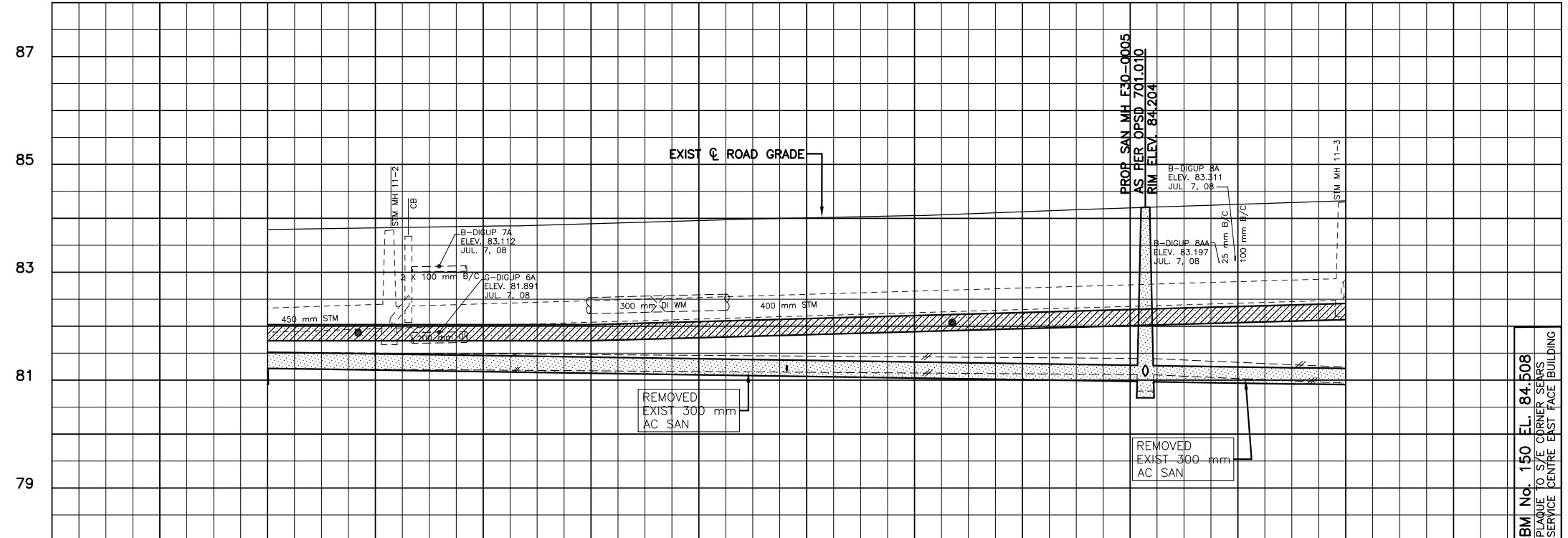

BM No. 150 EL. 84.508
PLAQUE TO S/E CORNER SEARS
SERVICE CENTRE EAST FACE BUILDING

1+260	1+270	1+280	1+290	1+300	1+310	1+320	1+330	1+340	1+350	1+360
PROP. 100.0-m OF 300 mm C-900, CL-150 PVC WATERMAIN CL 'P' BEDDING								98.3 m		
PROP. 82.16-m OF 300 mm VC SANITARY SEWER AT 0.30% GRADE, CL 'P' BEDDING								83.2 m		0.28%
PROP. 97.52-m OF 300 mm VC SANITARY SEWER AT 0.30% GRADE, CL 'P' BEDDING								97.3 m		
WM LENGTHS AND SIZES										
LENGTHS, SIZES AND GRADES										
SANITARY SEWER INVERT ELEV.										
C OF CONSTRUCTION CHAINAGE										

NOTE: ALL DIMENSIONS ARE IN METRES UNLESS OTHERWISE NOTED.

PROPOSED WATERMAIN DATA			
MARK	DESCRIPTION	CHAINAGE	TOP OF WATERMAIN ELEVATION
E	VERTICAL DEFLECTION	1+289.0	1+290.00 82.030
F	ANCHOR TEE, VALVE AND HYDRANT (STORZ TYPE)	1+323.50	82.218 82.48
M	TEMP FLUSHING HYDRANT	1+268.40	81.692 81.3
U	300 X 150 mm ANCHOR TEE AND VALVE	1+268.40	82.030 82.2

RESTORATION NOTES:
TRENCH RESTORATION IN ROADWAY AS PER S-514

- HL 4 - 40 mm
 - HL 8 - 100 mm (PGAC 64-28 - 2 Lifts)
 - GRAN. A - 100 mm
 - GRAN. B - 460 mm
- WATERMAIN TRENCH IN ASPHALT SURFACE SHALL BE MIN. 2.0 m WIDE, CUT IN STRAIGHT PARALLEL LINES.
ALL EXCAVATED MATERIAL BELOW GRANULAR TO BE REPLACED IN KIND.

- BOULEVARDS AND LAWNS: ASPHALT DRIVEWAYS:**
- 100 mm TOPSOIL
 - No. 1 NURSERY SOD
 - HL 3-50 mm MIN.
 - GRAN. A-150 mm

- CURBS & SIDEWALKS:**
- CURBS AS PER OS-601
 - SIDEWALKS AS PER OS-301

- NOTES:**
- FOR WATERMAIN CONSTRUCTION NOTES, REFER TO DRAWING NO. 0-07-W-1232
 - FOR SANITARY SEWER CONSTRUCTION NOTES, REFER TO DRAWING NO. 0-07-SW-1234
 - FOR GENERAL CONSTRUCTION NOTES, REFER TO DRAWING NO. 0-07-W-1233

1	FEB 18/14	A.B.	AS RECORDED (C. WRIGHT)
REVISIONS			
NO.	DATE	NAME	REVISIONS

LOCATION APPROVAL

CITY OF XXXXXX	XXXX XX XX
CABLE T.V.	2009 10 14 HYDRO 2009 10 23
BELL CANADA	2009 10 05 CITY OF OSHAWA 2007 11 20
ENBRIDGE GAS	2009 10 14

APPROXIMATE UTILITY LOCATIONS ARE SHOWN PER MARK-UPS RECEIVED FROM THIRD PARTIES ON THE DATES NOTED ABOVE. CONTRACTOR TO BE RESPONSIBLE FOR LOCATION OF ALL EXISTING U/G & OVERHEAD UTILITIES. VARIOUS UTILITIES REQUIRE ADVANCE NOTICE PRIOR TO DIGGING. FOR STAKE OUT. THE REGION ASSUMES NO RESPONSIBILITY FOR THE ACCURACY OF THE LOCATION OF EXISTING UTILITIES AS INDICATED ON THIS DRAWING.

REGISTERED PROFESSIONAL ENGINEER
PROVINCE OF ONTARIO

SURVEY DATA DATE: 2002 02 02
SCALE: HORIZONTAL 5m, VERTICAL 1m

DRAWN: C. SMITH
DESIGN: C. SMITH
CHECKED: P. JONES
APPROVED: A. SMITH

DATE: 2010 03
DATE: 2010 03
DATE: 2010 03
DATE: 2010 03

THE REGIONAL MUNICIPALITY OF DURHAM
WORKS DEPARTMENT
WHITBY ONTARIO

FAREWELL ST. (REG. RD. 56)
FROM 245.0 m N. OF HARBOUR RD. (REG. RD. 62)
TO 90.0 m S. OF MARWOOD DR.

CONCESSION	REG. RD. NO.	AREA MUNICIPALITY
BF	56	CITY OF OSHAWA
DRAWING NUMBER	CONTRACT NUMBER	SHEET NUMBER
SW-1	D2XXX-XX	07 OF 12

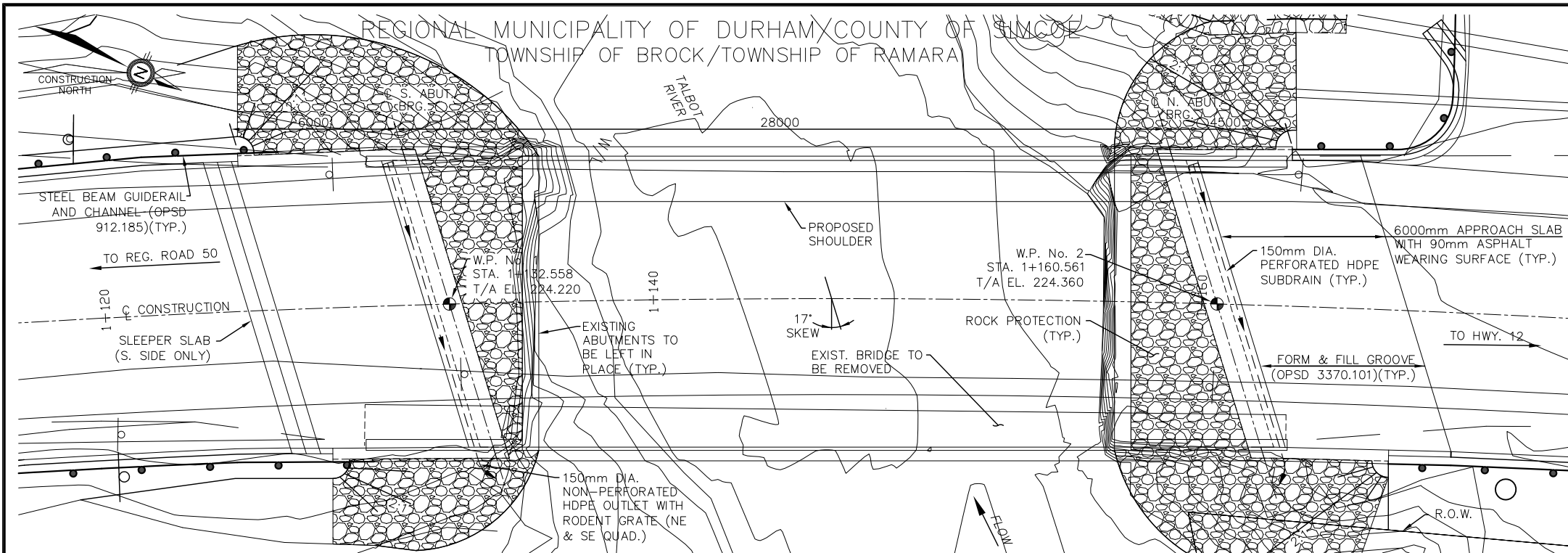

GENERAL NOTES

SPECIFICATIONS

- ONTARIO PROVINCIAL STANDARD SPECIFICATIONS, MUNICIPAL-ORIENTED, LATEST REVISION.
- CANADIAN HIGHWAY BRIDGE DESIGN CODE, CSA-S6-14.
- LIVE LOAD C.H.B.D.C.-14+90mm ASPHALT AND WATERPROOFING SYSTEM.

CONCRETE

- ALL CONCRETE SHALL BE IN ACCORDANCE WITH C.S.A. A23.1/A23.2-09

LOCATION	EXPOSURE CLASS	MIN. COMPRESSIVE STRENGTH AT 28 DAYS	MAX. AGG. SIZE (mm)	CLEAR COVER TO REINF.* (mm)
ABUTMENTS & WINGWALLS	C1	35MPa	19	70±20
FOOTINGS	F1	35MPa	19	70±20
DECK & CURBS	C1	35MPa	19	70±20 TOP 40±10 BOT.
END POSTS	C1	35MPa	19	60±10
PRECAST GIRDERS	C1	50MPa	19	AS NOTED
MASS CONCRETE	F1	40MPa	19	N/A
ALL OTHER CONCRETE	C1	35MPa	19	70±20

* UNLESS NOTED OTHERWISE ON DRAWINGS.

REINFORCING STEEL

- ALL CARBON STEEL REINFORCING SHALL BE IN ACCORDANCE WITH C.S.A. STANDARD CAN/CSA-G30.18 (LATEST REVISION), GRADE 40W UNLESS NOTED OTHERWISE.
- STAINLESS STEEL REINFORCING SHALL BE IN ACCORDANCE WITH ASTM A955/A955M.
- STAINLESS STEEL REINFORCING SHALL BE TYPE 316LN OR DUPLEX 2205 AND HAVE A MINIMUM YIELD STRENGTH OF 500 MPa.
- BAR MARKS WITH PREFIX 'S' DENOTE STAINLESS STEEL BARS.
- BAR HOOKS SHALL HAVE STANDARD HOOK DIMENSIONS USING MINIMUM BEND DIAMETERS, WHILE STIRRUPS AND TIES SHALL HAVE MINIMUM HOOK DIMENSIONS.
- UNLESS OTHERWISE SHOWN, TENSION LAP LENGTHS NOT INDICATED ON CONTRACT DRAWINGS SHALL BE CLASS 'B'.

CONSTRUCTION

- ALL EXPOSED EDGES TO BE CHAMFERED 25mm UNLESS OTHERWISE NOTED.
- BACKFILL BOTH SIDES OF STRUCTURE SIMULTANEOUSLY IN 250mm LAYERS, KEEPING THE HEIGHT OF THE BACKFILL APPROXIMATELY THE SAME. AT NO TIME SHALL THE DIFFERENCE IN ELEVATION BE GREATER THAN 500mm.

APPLICABLE STANDARD DRAWINGS

OPSD 912.130	GUIDE RAIL SYSTEM, STEEL BEAM STEEL POST WITH OFFSET BLOCK ASSEMBLY
OPSD 912.315	GUIDE RAIL SYSTEM, STEEL BEAM TRANSITION FROM TYPE M TO STEEL BEAM GUIDE RAIL WITH CHANNEL FOR STRUCTURE CONNECTION
OPSD 912.430	GUIDE RAIL SYSTEM STEEL BEAM STRUCTURE CONNECTION
OPSD 3370.100	DECK, WATERPROOFING HOT APPLIED ASPHALT MEMBRANE WITH PROTECTION BOARD
OPSD 3370.101	DECK, WATERPROOFING HOT APPLIED ASPHALT MEMBRANE AT ACTIVE CRACKS GREATER THAN 2MM WIDE AND CONSTRUCTION JOINTS
OPSD 3390.100	DECK DRIP CHANNEL
OPSD 3419.100	BARRIERS AND RAILINGS - STEEL GUIDE RAIL AND CHANNEL ANCHORAGE

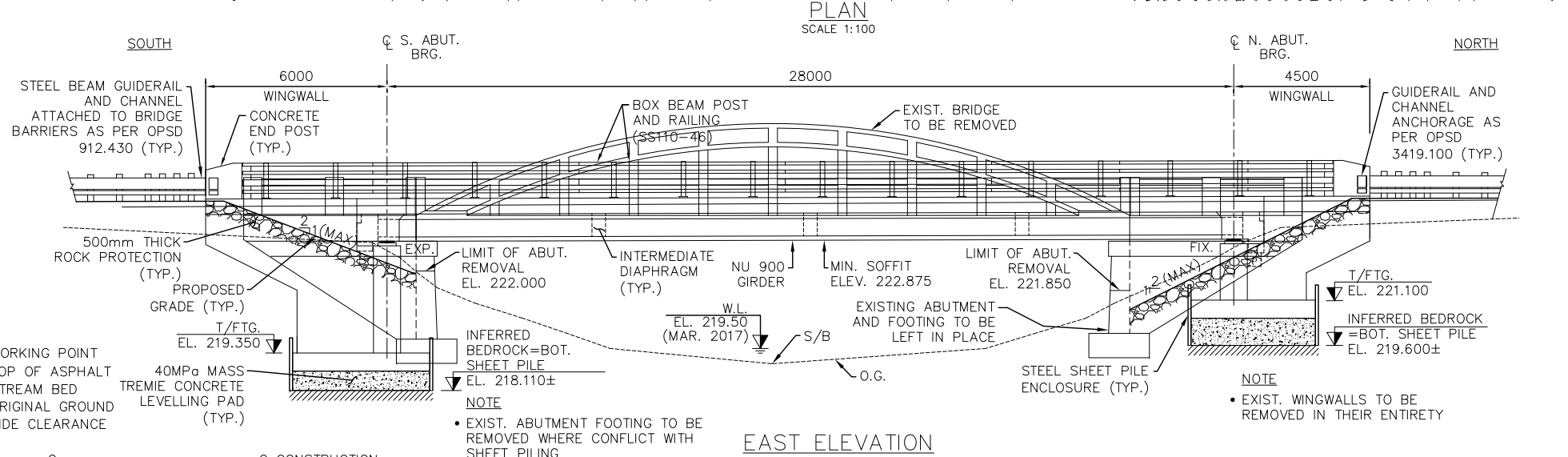

- NOTES**
- W.P. DENOTES WORKING POINT
 - T/A DENOTES TOP OF ASPHALT
 - S/B DENOTES STREAM BED
 - O.G. DENOTES ORIGINAL GROUND
 - S/C DENOTES SIDE CLEARANCE

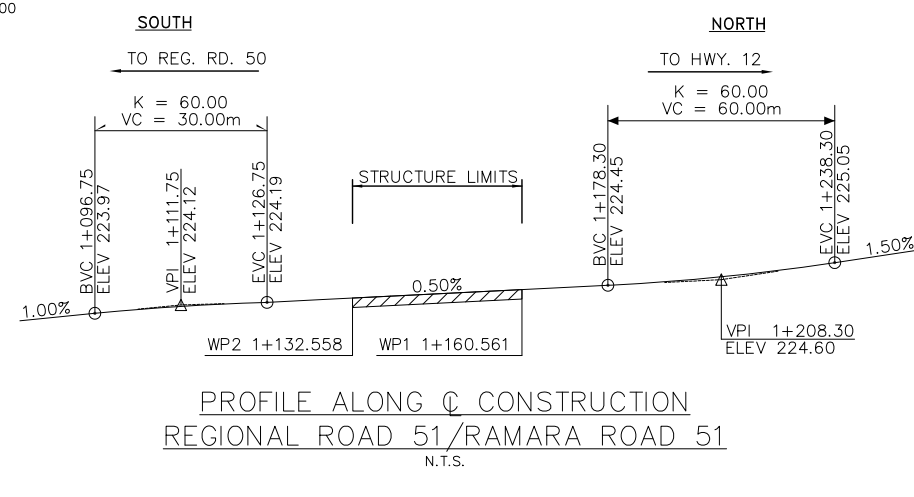
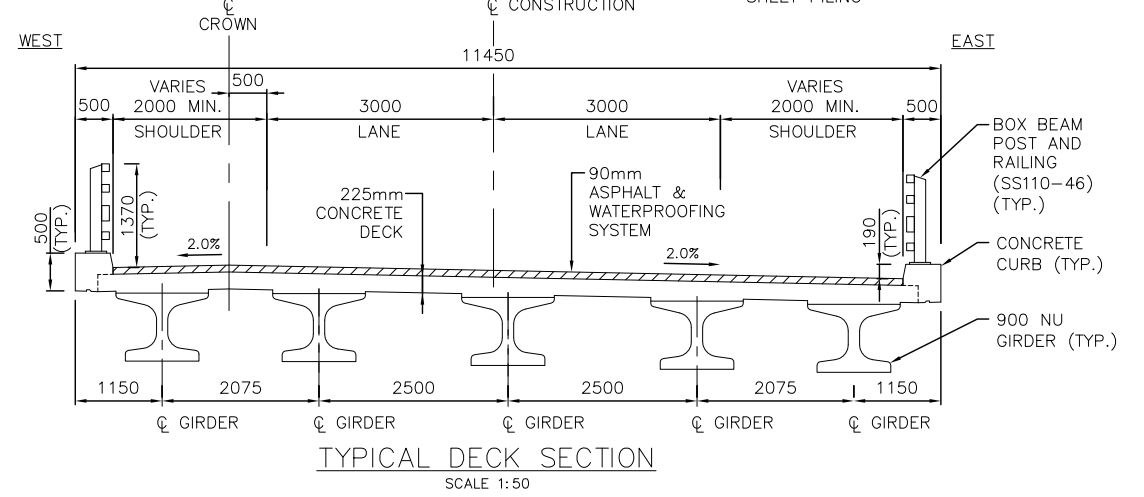

NOTE: ALL DIMENSIONS ARE IN MILLIMETRES UNLESS OTHERWISE NOTED.

CABLE T.V.	2017 11 14
BELL CANADA	2017 11 15
HYDRO ONE FOC	2017 11 15

APPROXIMATE UTILITY LOCATIONS ARE SHOWN PER MARK-UPS RECEIVED FROM THIRD PARTIES ON THE DATES NOTED ABOVE. CONTRACTOR TO BE RESPONSIBLE FOR LOCATION OF ALL EXISTING U/G & OVERHEAD UTILITIES. VARIOUS UTILITIES REQUIRE ADVANCE NOTICE PRIOR TO DIGGING, FOR STAKE OUT. THE REGION ASSUMES NO RESPONSIBILITY FOR THE ACCURACY OF THE LOCATION OF EXISTING UTILITIES AS INDICATED ON THIS DRAWING.

NO.	DATE	NAME	REVISIONS

DRAWN: X. Xxxxx	DATE: 2017 07
DESIGN: X. Xxxxx	DATE: 2017 07
CHECKED: X. Xxxxx	DATE: 2017 07
APPROVED: X. Xxxxx	DATE: 2017 07

AREA MUNICIPALITY
TOWNSHIP OF BROCK/TOWNSHIP OF RAMARA

SURVEY DATA DATE 2017/03/23	CONCESSION XI	REG. RD. NO. 51
--------------------------------	------------------	--------------------

THE REGIONAL MUNICIPALITY OF DURHAM
WORKS DEPARTMENT
WHITBY ONTARIO

**GAMEBRIDGE BRIDGE REPLACEMENT
OVER TALBOT RIVER
GENERAL ARRANGEMENT**

CONTRACT NO. D20XX-XX
DRAWING NO. S1
SHEET 15 OF 31