

NON-FERROUS WM

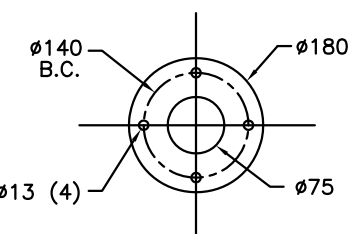

BASE BOLT SPACING DETAIL

NOTES

1. WATERMAIN SHALL BE TAPPED UNDER PRESSURE.
2. ALL STATIONS SHALL BE ENCLOSED IN A LOCKABLE NONREMOVABLE, ALUMINUM-CAST HOUSING.
3. ALL WORKING PARTS SHALL BE BRASS AND REMOVABLE FROM ABOVE GROUND WITH NO DIGGING
4. FOR CONNECTION DETAILS TO FERROUS WATERMAIN REFER TO S-230.020
5. LOCATION OF SAMPLING STATION AND CURB STOP SHALL BE DETERMINED BY THE REGION OF DURHAM.
6. A DECAL PROVIDED BY THE REGION OF DURHAM SHALL BE AFFIXED TO THE FRONT OF THE SAMPLING STATION DOOR.

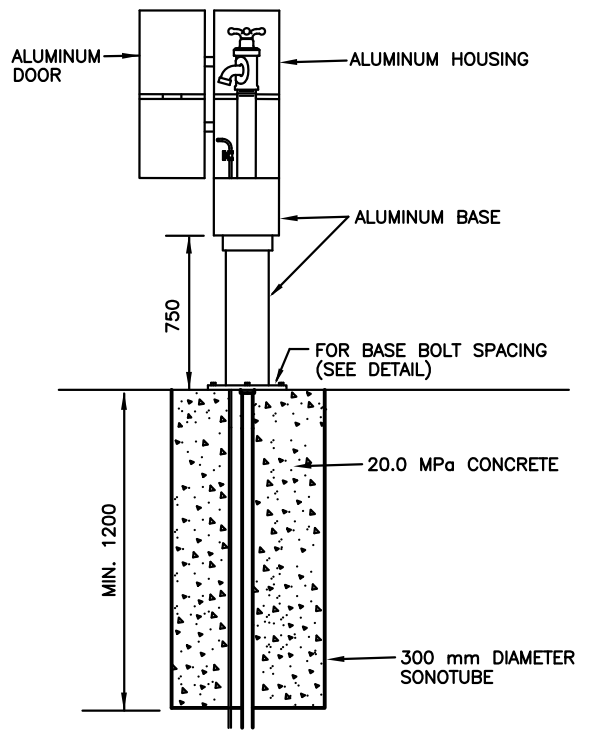

SAMPLING STATION ON PEDESTAL

ALL DIMENSIONS IN MILLIMETRES EXCEPT WHERE NOTED.



WATER SAMPLING STATION

DWG. DATE: 2003 06
REVISION NO.: 2
REV. DATE: 2013 04
SCALE: N.T.S.

S-210.070