

BREAK OFF AND PLUG EXISTING RIGID PVC DUCT FLUSH WITH EXISTING FOOTING

BRUSH TOP SURFACE AND EDGE TO GIVE "SIDEWALK FINISH"

SURFACE OF EXTENSION SHALL BE LEVEL WITH EXISTING CONCRETE FOOTING

EXISTING 2 - 75mm RIGID PVC DUCTS

DRILL 19mm HOLE 150mm DEPTH INTO EXISTING SLAB, PLACE 650mm LONG 15M BAR, FILL WITH DOWEL ADHESIVE (TYP. 3 LOCATIONS)

EXISTING CONCRETE FOOTING

EXISTING 32mm RIGID PVC DUCT

PLAN

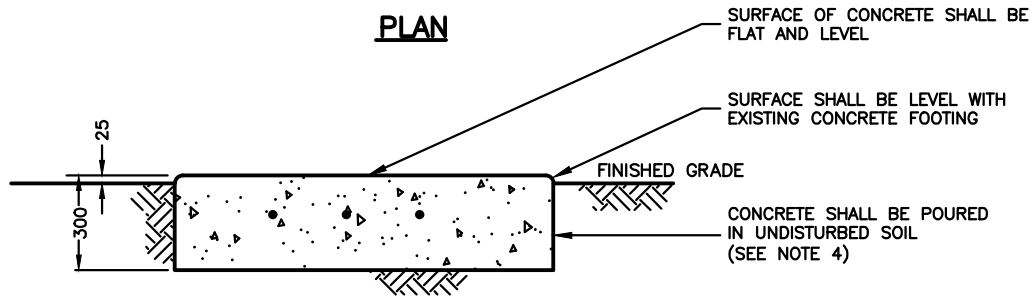

SURFACE OF CONCRETE SHALL BE FLAT AND LEVEL

SURFACE SHALL BE LEVEL WITH EXISTING CONCRETE FOOTING

CONCRETE SHALL BE POURED IN UNDISTURBED SOIL (SEE NOTE 4)

SECTION A-A

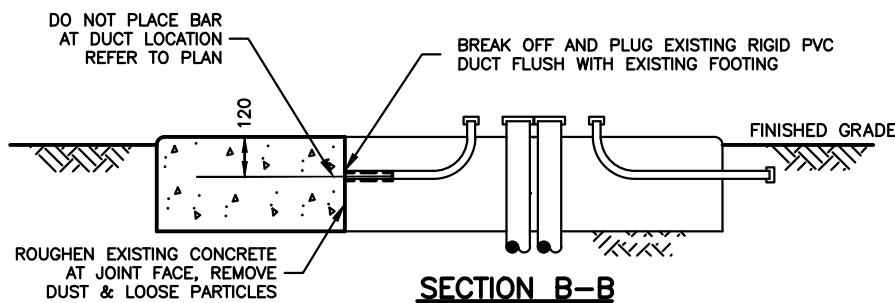

DO NOT PLACE BAR AT DUCT LOCATION REFER TO PLAN

BREAK OFF AND PLUG EXISTING RIGID PVC DUCT FLUSH WITH EXISTING FOOTING

ROUGHEN EXISTING CONCRETE AT JOINT FACE, REMOVE DUST & LOOSE PARTICLES

SECTION B-B

NOTES

1. ALL DUCTS SHALL BE CSA C22.2 #211-2 APPROVED OR SUBSEQUENT REVISION THEREOF.
2. ALL FITTINGS SHALL BE MOULDED OR FABRICATED FROM MATERIAL COMPATIBLE WITH THE DUCT MATERIAL. ALL JOINTS MUST CONFORM TO MANUFACTURERS RECOMMENDED PRACTICE.
3. FORM WITH 20mm PLYWOOD BRACED AROUND ENTIRE PERIMETER TO PREVENT WARPING.
4. CONCRETE SHALL BE CSA SPECIFICATION C-1 35 MPa CLASS OF EXPOSURE IN ACCORDANCE WITH CSA A23.1-09. TABLE 1 & 2.

ALL DIMENSIONS IN MILLIMETRES EXCEPT WHERE NOTED.



WORKS DEPARTMENT

TRAFFIC CONTROLLER CABINET FOOTING EXTENSION

DWG. DATE:	2016 04
REVISION NO.:	3
REV. DATE:	2022 04
SCALE:	N.T.S.

S-400.022